

THE MEDWAY

FOUR BEDROOM HOME



Designed with growing families in mind, the Medway is a spacious home with bright living spaces you'll love. To the ground floor you'll find an inviting lounge with bay window to the front and French doors to the rear which leads out onto the garden. There's a spacious open plan dining kitchen with French doors that create a lovely bright and airy space, along with a private study/extra reception room. There's also a utility room providing extra storage space and a cloakroom.

Upstairs there's a generous principal bedroom with en-suite and built-in wardrobe, three further bedrooms and a modern family bathroom with a bath and separate shower cubicle.

Outside there is a fully turfed garden, driveway, EV charger, and double garage.

THE MEDWAY

FOUR BEDROOM HOME



Separate lounge



Open plan kitchen, dining, and family area with French doors



Useful utility room



Principal bedroom with en-suite



High quality kitchen appliances



Hive smart heating system



Fully turfed rear garden



EV charger & double garage



Ground Floor

Ground Floor

Lounge	16'4" x 11'1"	4.98m x 3.39m
Kitchen/Dining	26'5" x 19'11"	8.06m x 6.09m
Utility	9'9" x 6'0"	2.99m x 1.85m
Cloakroom	5'5" x 3'4"	1.69m x 1.02m

First Floor

Bedroom 1 En-suite	14'11" x 11'1" 7'5" x 4'7"	4.57m x 3.39m 2.28m x 1.40m
Bedroom 2 En-suite	10'7" x 9'0" 6'6" x 5'10"	3.25m x 2.75m 1.99m x 1.80m
Bedroom 3	11'3" x 9'0"	3.43m x 2.75m
Bedroom 4	10'1" x 8'9"	3.08m x 2.68m
Bathroom	8'2" x 6'6"	2.49m x 1.99m

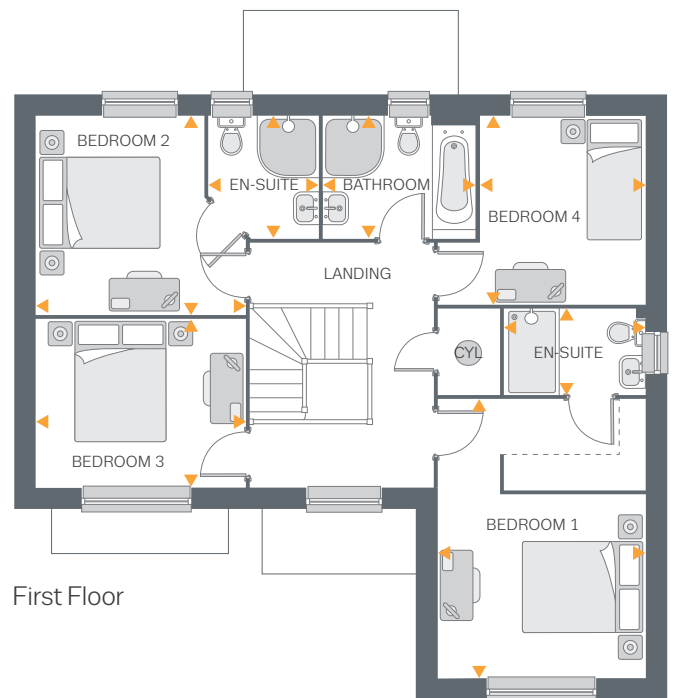

First Floor

----- Optional extra