

The Solway

3-bedroom home

The Solway is an impressive 3-bedroom home with plenty of living space spread across three perfectly laid-out floors. On the ground floor you'll find a spacious lounge and a separate open-plan kitchen and dining area with French doors providing attractive views of the garden. In summer, you can throw the doors open and step outside for that family BBQ or a spot of al fresco dining.

Up the stairs to the first floor are bedrooms two and three, which share a large family bathroom with shower and bathtub and offer plenty of choice whether you want to create a nursery, guest bedroom or home office. The principle bedroom has the prime space on the second floor and features a walk-in wardrobe and en-suite shower room.



313221.HABM_0101



All drawings, plans, and images are for illustrative purposes only. Room measurements are approximate. Finishes and layouts may vary and, during the construction process, plans might be subject to change. For more information, speak to your sales consultant.

Features

- Open-plan kitchen and dining area with French doors opening onto turfed garden
- Spacious separate lounge
- Downstairs cloakroom
- Modern family bathroom with shower and bathtub on the first floor
- Principle bedroom en-suite shower room on the second floor
- High quality Smeg kitchen appliances
- Walk-in wardrobe for principle bedroom
- Built-in wardrobe in second bedroom
- HIVE smart home system

Room Dimensions

Ground Floor

LOUNGE

Arrow A	3600mm	11'9"
Arrow B	3081mm	10'1"
Arrow C	4882mm	16'0"
Arrow D	3626mm	11'10"

KITCHEN/DINING ROOM

Arrow A	3600mm	11'9"
Arrow B	4653mm	15'3"
Arrow C	3821mm	12'6"
Arrow D	2585mm	8'5"

CLOAKROOM	960mm x 1859mm	3'1" x 6'1"
-----------	----------------	-------------

First Floor

BATHROOM

Arrow A	2581mm	8'5"
Arrow B	1899mm	6'2"
Arrow C	1826mm	5'11"
Arrow D	2521mm	8'3"

BEDROOM 2

Arrow A	2656mm	9'6"
Arrow B	3998mm	27'0"
Arrow C	3072mm	18'6"
Arrow D	2377mm	7'9"

WARDROBE	560mm x 2377mm	1'10" x 7'9"
----------	----------------	--------------

BEDROOM 3	2584mm x 3712mm	8'5" x 12'2"
-----------	-----------------	--------------

Second Floor

BEDROOM 1

Arrow A	3534mm	11'7"
Arrow B	4651mm	15'3"
Arrow C	4658mm	15'3"

WARDROBE	2414mm x 2091mm	7'11" x 6'10"
ENSUITE	2145mm x 2091mm	7'0" x 6'10"

Ground Floor

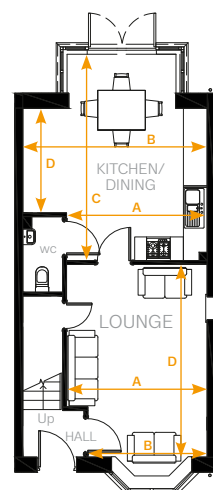

First Floor

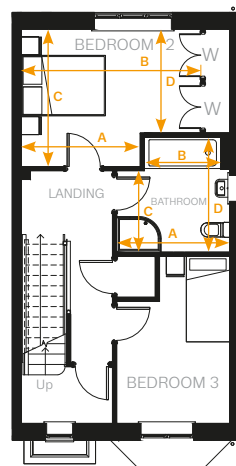

Second Floor

