

# The Derwent

---

## 2-bedroom home

Designed for open-plan living, the Derwent is an attractive modern home laid out on one floor. Step through its attractive gabled porch and you'll come up the stairs onto the heart of a really inviting home. There's a spacious, open-plan kitchen, dining and living area, perfect for entertaining and unwinding. You'll also find two generous bedrooms, great storage spaces and a beautiful new family bathroom.



# Features

- Open-plan kitchen, dining and living area
- High-quality Smeg kitchen appliances
- Stainless steel integrated oven, hob and chimney extractor fan
- 2 bedrooms, 1 with built-in wardrobes
- Family bathroom with shower over bathtub
- Single garage with driveway

## Room dimensions

### First Floor

LIVING/ DINING KITCHEN	6455(max) x 5350(max)mm	21'2" x 17'7"
BEDROOM 1	3127x 2739 mm	10'3" x 9'0"
BEDROOM 2	3109 x 2355 mm	10'2" x 7'9"
BATHROOM	2009 x 1875 mm	6'7" x 6'2"

Ground Floor

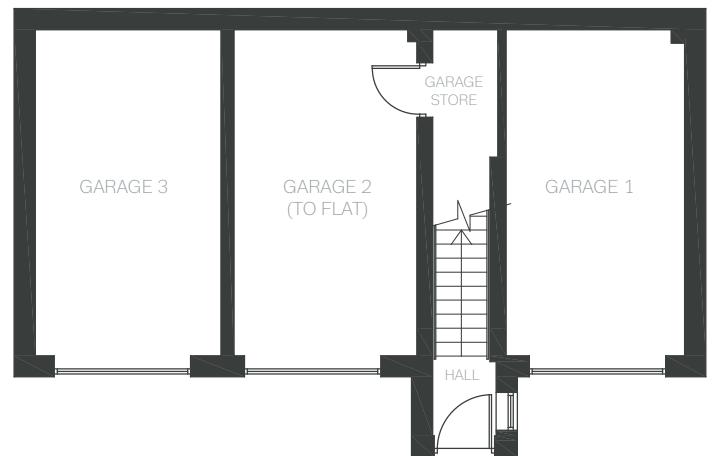

First Floor

